

A large, faint background graphic consisting of the letters 'H', 'C', and 'S' arranged in a grid. The 'H' is in a yellow square, the 'C' is in a purple square, and the 'S' is in a green square. The letters are white and have a slight shadow.

**Return to school with  
Covid -19**

**Hartstown/Huntstown  
Community School**

***“WE ARE ALL IN THIS TOGETHER”***

# Welcome Back



**Wednesday 26<sup>th</sup> – All staff return**

**Thursday 27<sup>th</sup> of August**

**09.00 – 11.00**

All students of 1st and 5th Year (including LCA and Transition Year) to meet year-heads and tutors, for induction and timetables

**Friday 28<sup>th</sup> of August**

**09.00 – 11.00**

All students of 2nd, 3rd and 6th Year to meet year -heads and tutors for induction and timetables

**Monday 31<sup>st</sup> of August**

**08.52**

All students start at 08.52 with Tutorial class



# Induction Day

- Students will come in their assigned entrance
- Masks **must** be worn in to the school
- Students will reconnect with Year Head & Tutor
- Students will receive their timetable
- Students will receive a reusable mask
- Students will be given time to familiarise themselves with the new **One Way System, New Classroom Routines, New Entrances & Exits**



# Note for Parents

- If your child is unwell, please **do not** send your child to school
- You will **not** be able to access the school building without an appointment
- Please wash your child's uniform & PE uniform regularly
- Make sure your child has their mask with them every day for school
- Encourage your child to engage in good respiratory measures and good hand hygiene



# Note for Parents

- If a student has no mask they can buy a disposable mask in the main office, students **must** wear masks in the school unless instructed otherwise by their teachers.
- If a student misbehaves in regard to the wearing of masks, use of masks etc, there will be sanctions as outlined in the charter of behaviour (COVID 19 section)



# New Student Entrances

The school will not open until **8.30am**

<b>1<sup>st</sup> Years</b>	<b>2<sup>nd</sup> Years</b>	<b>3<sup>rd</sup> Years</b>	<b>TY</b>	<b>5<sup>th</sup> Years</b>	<b>6<sup>th</sup> Years</b>
<b>Middle Entrance (Blue)</b>	<b>Front Door (Red)</b>	<b>Back Door (Green)</b>	<b>Annex</b>	<b>Side Door + Go Upstairs (Orange)</b>	<b>Science (Yellow)</b>



# Assembly & Tutorial

- Each Year Group has 1 assembly in the PE Hall
- Assembly starts at 8.42am
- If you do not have assembly, tutorial starts in their base room at 8.52am every morning
- Students must wear a mask

6 <sup>th</sup> Years	5 <sup>th</sup> Years	TY	3 <sup>rd</sup> Years	2 <sup>nd</sup> Years	1 <sup>st</sup> Years
Monday	Tuesday	Monday	Wednesday	Thursday	Friday



# Typical School Day

- Students will enter the school via their assigned door
- Adhere to our new **one way system**
- Walk on the **left side** on the corridor at all times
- There will be no stopping or congregating on the corridors during the change of class.



# One Way System

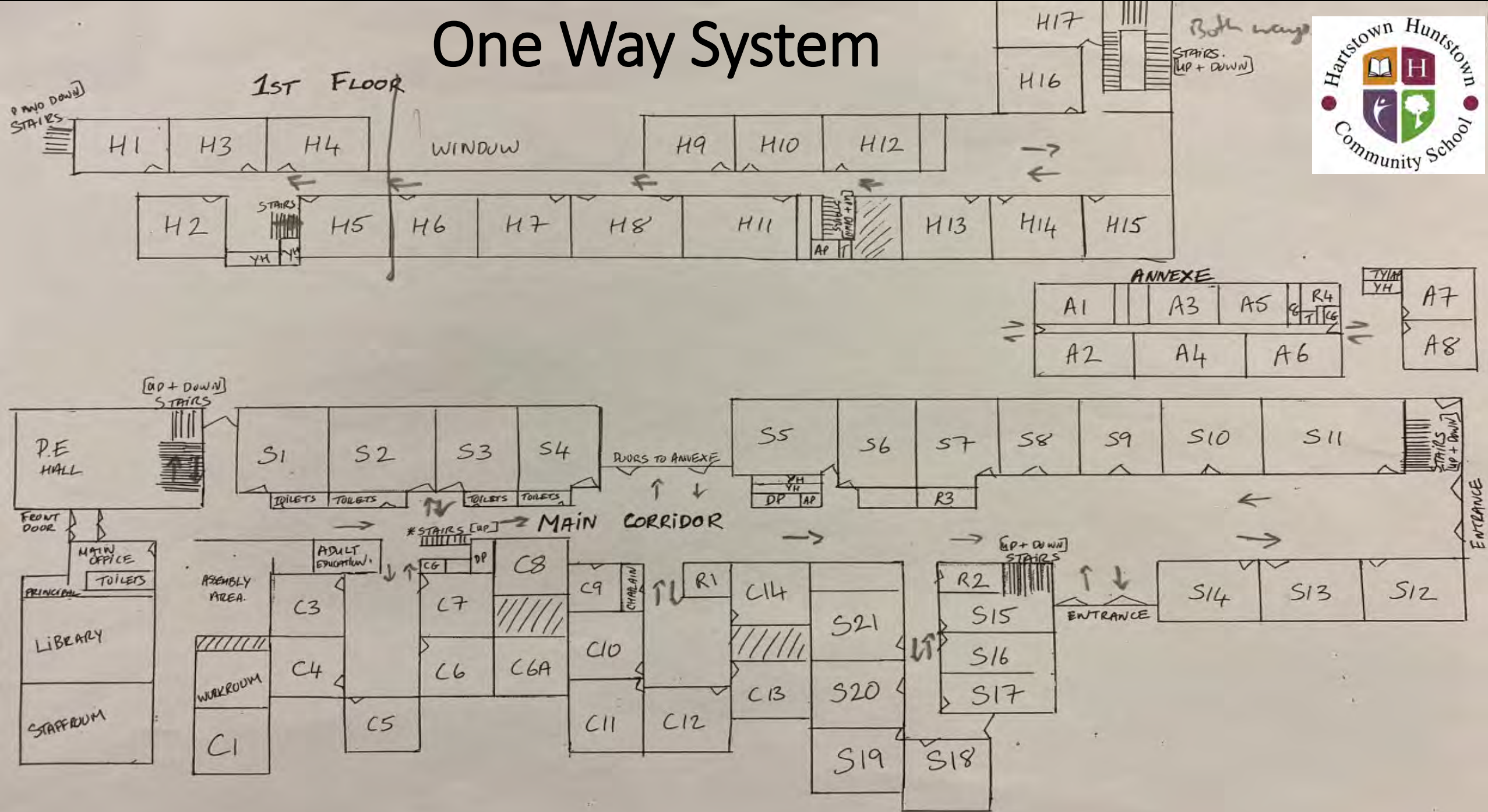

# ROOM SIZES

1ST FLOOR



Less than 24
Less than 20
Small Spaces



# Classroom Signs



>24

**You must  
wear your  
mask**



>20

**You must  
wear your  
mask**



Small Space

**You must  
wear your  
mask**



# New Classroom Rules

- On entering the classroom students will sanitise their hands at the station on the way in.
- Students will go straight to their assigned seat.
- Students will sanitise their work station at the end of every class
- Students will sanitise their hands on the way out of the classroom
- Students can not share equipment with others



# Lockers

- Students will not have access to lockers
- Students should organise their books for the morning & afternoon classes the night before coming to school



## What if a student feels unwell?

- Students should **not** come to school if they have any COVID 19 symptoms.
- If a student feels unwell throughout the day, we will phone the parents immediately to come and collect the student.



# Good Respiratory Measures

- Masks must be worn above nose and mouth
- Messing with masks will not be tolerated
- Students should avoid touching the face, eyes, nose and mouth
- Students should cough and sneeze into their elbow
- Students must dispose of tissues in a bin



# Entering the building after lunch

- Students will enter the school at the entrance which is closest to their first class.
- Students **must** wear a mask





# Lunch

- We are restricted with the number of students who can stay in school for lunch, students must complete a form if they want to stay in the school at lunch time
- Students will not be able to use the canteen facilities, they must bring all of their own lunch, cutlery etc and this must be brought home with student.
- Students will have to sanitise their lunch area when they are finished.

# PE



- All changing rooms are out of use
- Students with PE timetabled for the morning time will wear PE uniform in the morning and change during lunch.
- Students with PE timetabled for the afternoon will change into PE gear during lunch.
- PE uniform must be appropriate
- Uniforms should be cleaned when PE uniforms are being worn.

# Exiting the Building @ 11.40 & 15.20



- Students will exit the building at 11.40 and 15.20 at their nearest exit.
- Students must leave the building promptly to allow cleaning staff to commence their work.



# Frequency of Hand Hygiene

- before and after eating and preparing food
- after coughing or sneezing
- after using the toilet
- where hands are dirty
- before and after wearing gloves
- before and after being on public transport
- before leaving home
- when arriving/leaving the school /other sites
- after each class
- after touching potentially contaminated surfaces
- if in contact with someone displaying any COVID-19 symptoms

# How do I wash my hands?



<https://www.hse.ie/eng/about/who/healthwellbeing/our-priority-programmes/hcai/hand-hygiene-in-irish-healthcare-settings/hand-hygiene-videos/>